



Mulberry Court, School Mews E1

Leasehold
3 Bed 2 Bath
961 sqft (approx)

Situated on the 3rd & 4th floor of the unique and private gated Victorian school conversion Mulberry Court located in Shadwell. This 3 bed 2 bath, duplex apartment boasts 961sqft (approx) of well appointed living space.

- Original School Conversion
- Duplex Apartment
- Modern Interior



The Bespoke Agent™

On the 3rd floor, you'll find a bright open-plan kitchen/living area, complete with integrated appliances and complemented by sash double-glazed windows throughout. The versatile third bedroom can also be found on this floor, boasting a striking west-facing double-height window, this impressive space is currently styled as a study/office. The main bathroom completes the 3rd floor.

The 4th floor comprises the primary bedroom, complete with a modern three-piece ensuite. Skylights flood the room with natural light, creating a bright and airy atmosphere. Opposite, the secondary bedroom features built-in wardrobes as well as plenty of dual eaves providing ample storage space.

Mulberry Court enjoys a peaceful, off-street setting while being exceptionally well connected. Shadwell Station (DLR and East London Line) and Tower Hill (Circle and District Lines) are just moments away, providing quick access across London. Whitechapel Station (Elizabeth Line) and Shoreditch High Street are also within easy reach, linking you directly to Brick Lane, Spitalfields, and the City.

The property is surrounded by a vibrant mix of shops, cafés, bars, and restaurants along Commercial Road, as well as the waterside attractions of Wapping and St Katherine's Dock. Here, you'll find some of London's most historic riverside pubs, including The Prospect of Whitby, The Captain Kidd, and The Town of Ramsgate, all perfect for soaking up the area's unique character.

Tenure: Leasehold

Lease Length: 110 years

Service Charge: £2,900 per annum (approx.)

Ground Rent: £350 per annum (approx.)

Parking: Resident Parking

Local Authority: Tower Hamlets

Council Tax Band: E

The Bespoke Agent™



Mulberry Court

Approx. Gross Internal Area 961 Sq Ft - 89.25 Sq M

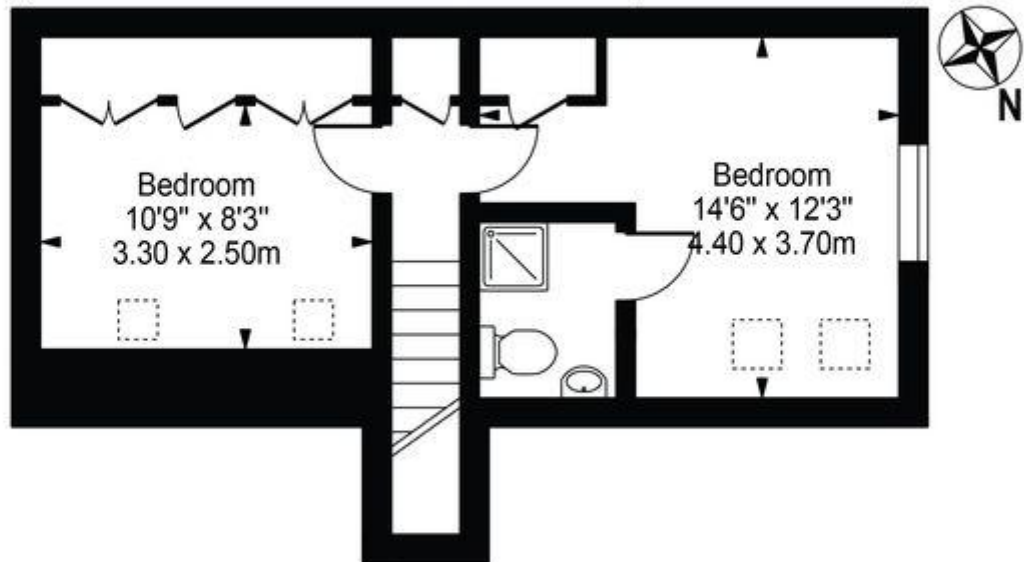

Fourth Floor



Third Floor

For Illustration Purposes Only - Not To Scale

This floor plan should be used as a general outline for guidance only and does not constitute in whole or in part an offer or contract. Any intending purchaser or lessee should satisfy themselves by inspection, searches, enquiries and full survey as to the correctness of each statement. Any areas, measurements or distances quoted are approximate and should not be used to value a property or be the basis of any sale or let.