



Old Nichol Street E2

1 Bed 1 Bath
456 sqft (approx.)

Situated on Old Nichol Street, this well-presented second-floor apartment offers just under 500 sqft (approx.) of bright and practical living space, comprising one double bedroom and one modern bathroom.

- Great location
- Secure building
- Built in storage

The Bespoke Agent™



The Bespoke Agent™

Finished to a good standard throughout, the property features dark wood flooring, custom-built wardrobes providing excellent storage, and a contemporary three-piece bathroom suite. The open-plan layout makes the space feel comfortable and functional, ideal for a professional tenant or couple looking to enjoy everything Shoreditch has to offer.

The location is a real highlight. Within a five-minute walk you'll find some of East London's most popular spots including The Boundary Rooftop, Shoreditch House, Dishoom and Boxpark, along with an ever-changing mix of cafés, restaurants, bars and independent shops.

Transport links are superb, with Shoreditch High Street Overground less than a two-minute walk away and Liverpool Street Station around a ten-minute walk via Bishopsgate, offering quick access to the City, Canary Wharf and beyond.

A fantastic opportunity to rent in one of London's most vibrant neighbourhoods.

Available From: Monday 09th March 2026

Furnishing: Part Furnished

Parking: N/A

Local Authority: Tower Hamlets

Council Tax Band:

The Bespoke Agent™



Old Nichol Street

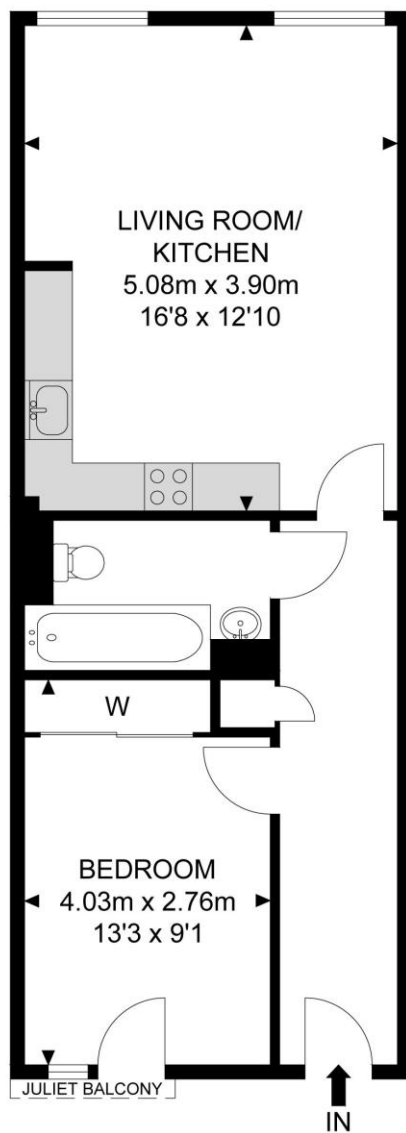

1st Floor

APPROX. GROSS INTERNAL FLOOR AREA 456.38 SQ FT / 42.40 SQM

Whilst every attempt has been made to ensure the accuracy of the floor plan contained here, measurements of doors, windows, rooms and any other items are approximated and no responsibility is taken for any error, omission or mis-statement. This plan is for illustrative purposes only and should be used as such by any prospective purchaser. The service, system and appliances shown have not been tested and no guarantee as to their operability or efficiency can be given.

© SpacePhoto

Photography and Floor Plan